

EUHOMY

Live the *cool life*



SCAN HERE to activate your warranty and become part of the Euhomy community!

Monthly Clean Guide

Don't forget to deep clean your ice maker monthly using an ice maker cleaner and descaler. Let the cleaning solution stand in the unit for at least half an hour.

* Check our User Manual for more maintenance ideas.

FAQs

? Why do my ice cubes melt quickly?

The machine doesn't refrigerate ice. Keeping the lid closed can slow the melting of ice cubes or transfer ice to a fridge for storage. The melted water will flow back into the water reservoir and then be recirculated to start the ice-making process again.

? Can I put milk or juice in the water reservoir?

No. Milk or juice can clog the pump and damage the machine.

? How often should I clean my ice maker?

Clean at least once a week to prevent scale buildup that can block the pump and cause malfunctions.

? Why is the Add Water light on while I have enough water in the reservoir?

Please try unplugging the machine for 2 hours and restart the machine to see if the light is still on.

? Why is the Ice Full light on while I have no ice in the ice bin?

Please try move the ice machine to a darker location to restart ice-making.

? Why is water leaking from the machine?

Ensure the drain plug is inserted into the machine. To assist you further, please contact the Euhomy Team with a video or photo of the issue.

? Why is the Ice Full light on but the ice maker won't stop?

Please try block the ice full sensor with your finger. If the indicator doesn't change, please contact support@euhomy.com.

Please refer to the product manual for more detailed information on:



usage



cleaning



maintenance



troubleshooting

support@euhomy.com

1-833-362-2655(US)

<https://euhomy.com>

EUHOMY

QUICK GUIDE

for IM013-N nugget Ice Maker

IM003-BBL-USEH

IMPORTANT SAFETY INSTRUCTIONS

 Let the machine sit for **24 hours** on a stable, level surface before first use to allow the refrigerant to settle. **Damage caused by skipping this step is not covered under warranty.**

 Keep the appliance and cord out of children's reach. Close supervision is necessary when used near children.

 Install on a stable surface according to the instructions.

 **DO NOT** store items on top during use.

 **DO NOT** use outdoors or expose to sunlight.

1. SETUP

Unpack

Remove packaging and check accessories (manual, scoop).



Settle Refrigerant

Place the machine on a level surface and let it sit for 24 hours to allow the refrigerant to settle before proceeding with setup and use.

Position

Place on a level surface, away from heat, with **6 inches** clearance at the air outlet.

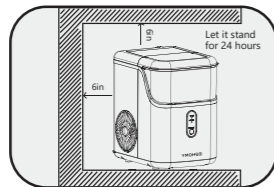

SCAN HERE to watch the installation, usage, cleaning videos and more information.

2. FIRST-TIME CLEANING BEFORE USE



• **External cleaning:** Turn off the power and clean the exterior of the ice machine with a dry cloth.



• **Clean the ice bin:** Clean with warm water and a soft cloth.



• **Clean the interior:** Clean all internal parts that are recommended to come in contact with water. We recommend using our ice maker-specific cleaner.



*We recommend using our ice maker-specific cleaner.

Install the cord

Remove the top cover and get out the power cord. Then, back the top cover.

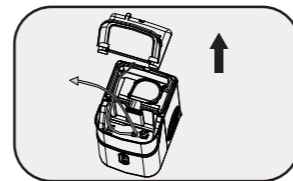

Plug Accessibility

The power plug must be accessible directly. Position the appliance so that the plug is easily accessible.

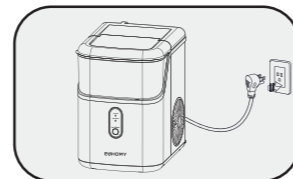

* If there is a protective film, it can be removed.



• **Drain:** Remove the drain plug after cleaning to empty the reservoir. If you use ice maker-specific cleaner to clean the machine, please use water clean the machine again.

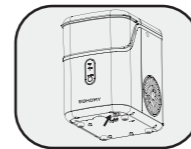

• **Install the drain plug again:** After draining is complete, reinstall the drain plug.

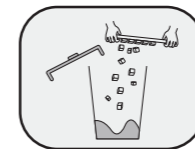

• **Run the ice making cycle:** Run the water for 1-2 ice making cycles, discarding all ice and water to ensure thorough cleaning.

Tip: Please use drinking water, preferably purified bottled water. The quality of the water affects the clarity of the ice and the life of the ice maker.

3. ICE-MAKING PROCESS

Start

Take out the ice basket and fill the water tank with potable water - **0.3 gallons maximum**. Replace the ice basket. Plug in the power supply, and the ice maker will enter standby mode.

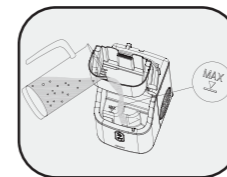

Standby Mode

In standby mode, the ring indicator light will turn red.

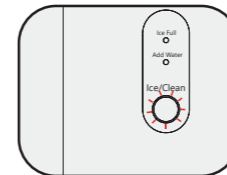

Making Ice

Press the **ICE/CLEAN** button to start the machine. The machine will begin making ice with the Ring Indicator Light turning white. Press the **ICE/CLEAN** button again to stop making ice.

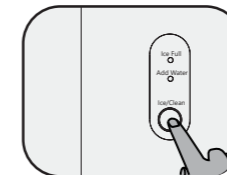

Retrieve Ice

Open the lid, scoop the ice, and close the lid for the next cycle.



Indicator On

• **ADD WATER Indicator On:** Please add water to the reservoir and restart the machine if the ADD WATER light is on.

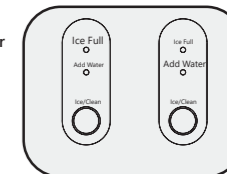

• **ICE FULL Indicator On:** Remove some ice from the ice basket to allow space for new ice. The machine will automatically start a new cycle once there's room.

4. CLEANING & MAINTENANCE

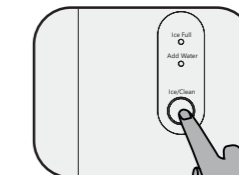

• In standby mode, press and hold **ICE/CLEAN** for 5 seconds until the Ring Indicator Light flashes white.

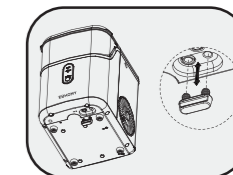

• Drain water and repeat if necessary.

We suggest you clean your ice maker at least once a week with a Nickel-Safe ice maker cleaner solution.